

# MASON GARTEN

REAL ESTATE



## 2/38 Dry Dock Road TWEED HEADS SOUTH NSW

3 2 1

Filtered water views are beautifully framed from the fully renovated interior of this deluxe two-level duplex villa rising from a revered riverfront address in Tweed Heads South.

The luxury renovations align the 160m<sup>2</sup> residence with lifestyle expectations of its idyllic location encompassing the picturesque riverside walking path to Coolangatta beach, access to the sheltered waters of the Tweed River for kayaking, stand up paddle boarding and swimming, and walkability to a host of cafes, shops and facilities.

CONTACT MASON GARTEN ON 0451 307 305 TO ARRANGE A PRIVATE INSPECTION.

Timber floorboards add warmth to the light-filled interior where glass doors open the living and dining space up to a sun-drenched side courtyard and covered alfresco

**Price** : \$ 685,000

**View** : <https://www.masongartenrealestate.com/sale/nsw/northern-rivers/tweed-heads-south/residential/townhouse/7229452>



**Mason Garten**  
0451 307 305

<https://www.masongartenrealestate.com>

# 2/38 Dry Dock Road, Tweed Heads South

3 2 1

internal: 118 m<sup>2</sup> | external: 33 m<sup>2</sup> | garage: 18 m<sup>2</sup> | total: 169 m<sup>2</sup>

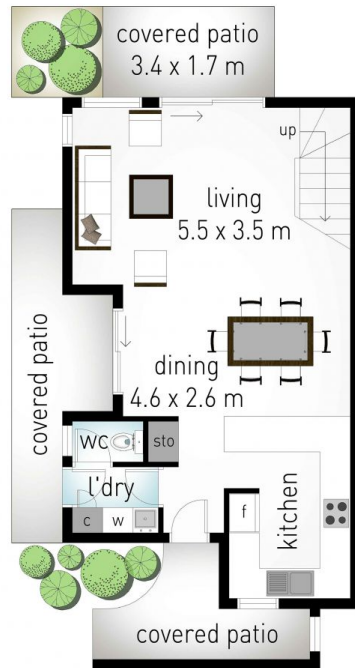
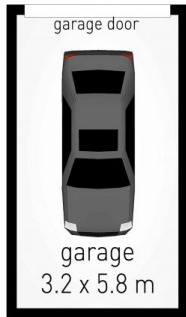

lower level



upper level



Dimensions are approximate. All information contained herein is gathered from sources we believe to be reliable. However we cannot guarantee its accuracy and interested persons should rely on their own enquiries.

